



SDC/P

Precision collet chuck for multi purpose machining



Features

- Improved precision by applying a bearing nut
- Reorganization of toolholder length standard compared to SDC
- ER collet chuck is suitable for general-purpose processing with the highest grade sleeve nut
- Chucking Range : $\varnothing 1 \sim \varnothing 26$



NAMING

BT30 — **SDC** — **10** — **P** — **100**
 Spindle Collet chuck Tool dia. Precision Length

Bearing nuts designed for improved precision

Soft Sleeve Bearing RN Nut



Jet coolant disk applicable

After replacing with RT/RUT nut, connect RTJW to use jet coolant – internal coolant



SDC/P Application

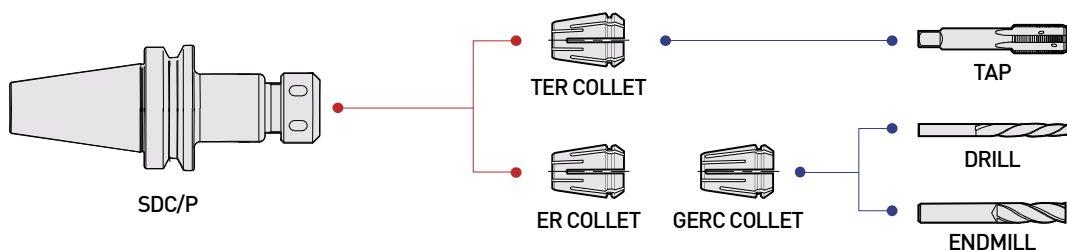

Spare Part

SPARE PART	Type	Main components		Type	Accessories	
		Sleeve bearing nut	Adjust screw		Spanner	Collet
	Images			Images		
	Model No.			Model No.		
	SDC7P	RN11	BN0716F	SDC7P	20-22	GERC/ER 11- \varnothing D
	SDC10P	RN16	BN1025F	SDC10P	32-35	GERC/ER 16- \varnothing D
	SDC13P	RN20	BN1325F	SDC13P	35-38	GERC/ER 20- \varnothing D
	SDC16P	RN25	BN1830F	SDC16P	42-46	GERC/ER 25- \varnothing D
	SDC20P	RN32	BN2230F	SDC20P	48-52	GERC/ER 32- \varnothing D
	SDC26P	RN40	BN2838F	SDC26P	62-65	GERC/ER 40- \varnothing D



DBT-SDC/P

Precision collet chuck for multi purpose machining



Fig.1

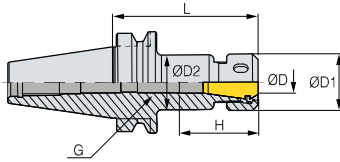

Fig.2

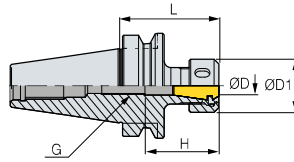
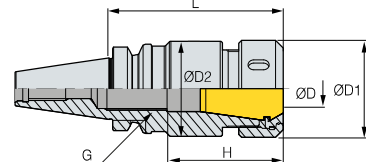

Fig.3



- : Stock
- H : Depth of tool insertion

C Internal coolant system is optional

※ Using oil hole types requires the standard dimension

- For more information on product features, see **86p**
- For more information on the related parts, see **92p**
- For more information on the applicable collet, see **95p**

	Designation	ØD	L	ØD1	ØD2	H	COLLET	G	Fig.	Kg	Package weight(Kg)	Stock
DBT30	DBT30-SDC7P-70	1.0~7.0	70	18	17	33	GERC11	M7	1	0.5	0.5	
	DBT30-SDC7P-100	1.0~7.0	100	18	17	33	GERC11	M7	1	0.5	0.6	
	DBT30-SDC10P-50	1.0~10.0	50	32	-	45	GERC16	M10	2	0.5	0.6	
	DBT30-SDC10P-70	1.0~10.0	70	32	31	45	GERC16	M10	1	0.6	0.6	●
	DBT30-SDC10P-100	1.0~10.0	100	32	31	45	GERC16	M10	1	0.7	0.9	
	DBT30-SDC13P-50	1.0~13.0	50	35	-	49	GERC20	M13	2	0.5	0.6	
	DBT30-SDC13P-70	1.0~13.0	70	35	34	49	GERC20	M13	1	0.6	0.7	
	DBT30-SDC13P-100	1.0~13.0	100	35	34	49	GERC20	M13	1	0.8	0.9	
	DBT30-SDC16P-50	2.0~16.0	50	42	-	50	GERC25	M18	2	0.5	0.6	
	DBT30-SDC16P-70	2.0~16.0	70	42	41	50	GERC25	M18	1	0.7	0.8	
	DBT30-SDC16P-100	2.0~16.0	100	42	41	50	GERC25	M18	1	1	1.1	
	DBT30-SDC20P-60	2.0~20.0	60	50	-	60	GERC32	M22	2	0.6	0.7	●
	DBT30-SDC20P-90	2.0~20.0	90	50	49	60	GERC32	M22	3	1.0	1.1	●
DBT30-SDC20P-120	2.0~20.0	120	50	49	60	GERC32	M22	3	1.4	1.5		
DBT40	DBT40-SDC7P-70	1.0~7.0	70	18	17	33	GERC11	M7	1	0.9	1.1	
	DBT40-SDC7P-90	1.0~7.0	90	18	17	33	GERC11	M7	1	0.9	1.2	●
	DBT40-SDC7P-130	1.0~7.0	130	18	17	33	GERC11	M7	1	1	1.2	
	DBT40-SDC10P-70	1.0~10.0	70	32	31	45	GERC16	M10	1	1	1.2	
	DBT40-SDC10P-90	1.0~10.0	90	32	31	45	GERC16	M10	1	1.2	1.4	●
	DBT40-SDC10P-130	1.0~10.0	130	32	31	45	GERC16	M10	2	1.4	1.5	●
	DBT40-SDC13P-70	1.0~13.0	70	35	34	49	GERC20	M13	1	1.1	1.2	
	DBT40-SDC13P-90	1.0~13.0	90	35	34	49	GERC20	M13	1	1.2	1.4	●
	DBT40-SDC13P-130	1.0~13.0	130	35	34	49	GERC20	M13	1	1.4	1.6	
	DBT40-SDC13P-150	1.0~13.0	150	35	34	49	GERC20	M13	1	1.6	1.8	
	DBT40-SDC16P-70	2.0~16.0	70	42	41	50	GERC25	M18	1	1.1	1.3	
	DBT40-SDC16P-90	2.0~16.0	90	42	41	50	GERC25	M18	1	1.3	1.5	●
	DBT40-SDC16P-130	2.0~16.0	130	42	41	50	GERC25	M18	1	1.7	1.9	
	DBT40-SDC20P-70	2.0~20.0	70	50	-	60	GERC32	M22	2	1.1	1.3	
	DBT40-SDC20P-90	2.0~20.0	90	50	49	60	GERC32	M22	1	1.4	1.6	●
	DBT40-SDC20P-130	2.0~20.0	130	50	49	60	GERC32	M22	1	1.9	2.2	●
	DBT40-SDC20P-150	2.0~20.0	150	50	49	60	GERC32	M22	1	2.2	2.5	
DBT40-SDC26P-90	16.0~25.0	90	63	62	71	GERC40	M28	1	1.7	1.9		

(Unit : mm)

Chuck

Arbor/Modular

Boring tool

Angular head

cBN/PCD

TAUMAX

Other



BT-SDC/P

Precision collet chuck for multi purpose machining

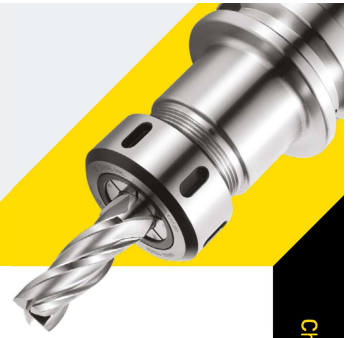

Fig.1

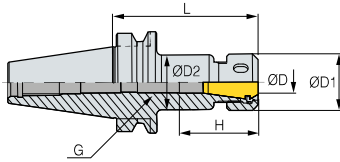

Fig.2

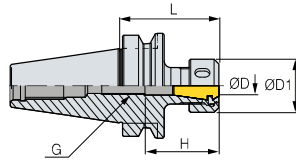
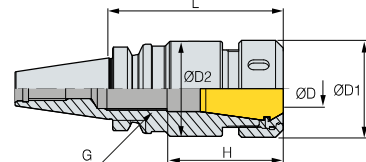

Fig.3



- : Stock
- H : Depth of tool insertion

C Internal coolant system is optional

※ Using oil hole types requires the standard dimension

- For more information on product features, see **86p**
- For more information on the related parts, see **92p**
- For more information on the applicable collet, see **95p**

	Designation	ØD	L	ØD1	ØD2	H	COLLET	G	Fig.	Kg	Package weight(Kg)	Stock
BT30	BT30-SDC7P-70	1.0~7.0	70	18	17	33	GERC11	M7	1	0.5	0.5	●
	BT30-SDC7P-100	1.0~7.0	100	18	17	33	GERC11	M7	1	0.5	0.6	●
	BT30-SDC10P-50	1.0~10.0	50	32	-	45	GERC16	M10	2	0.5	0.6	●
	BT30-SDC10P-70	1.0~10.0	70	32	31	45	GERC16	M10	1	0.6	0.6	●
	BT30-SDC10P-100	1.0~10.0	100	32	31	45	GERC16	M10	1	0.7	0.9	●
	BT30-SDC13P-50	1.0~13.0	50	35	-	49	GERC20	M13	2	0.5	0.6	●
	BT30-SDC13P-70	1.0~13.0	70	35	34	49	GERC20	M13	1	0.6	0.7	●
	BT30-SDC13P-100	1.0~13.0	100	35	34	49	GERC20	M13	1	0.8	0.9	●
	BT30-SDC16P-50	2.0~16.0	50	42	-	50	GERC25	M18	2	0.5	0.6	●
	BT30-SDC16P-70	2.0~16.0	70	42	41	50	GERC25	M18	1	0.7	0.8	●
	BT30-SDC16P-100	2.0~16.0	100	42	41	50	GERC25	M18	1	1.0	1.1	●
	BT30-SDC20P-60	2.0~20.0	60	50	-	60	GERC32	M22	2	0.6	0.7	●
	BT30-SDC20P-90	2.0~20.0	90	50	49	60	GERC32	M22	3	1.0	1.1	●
BT30-SDC20P-120	2.0~20.0	120	50	49	60	GERC32	M22	3	1.4	1.5	●	
BT40	BT40-SDC7P-70	1.0~7.0	70	18	17	33	GERC11	M7	1	0.9	1.1	●
	BT40-SDC7P-90	1.0~7.0	90	18	17	33	GERC11	M7	1	0.9	1.2	●
	BT40-SDC7P-130	1.0~7.0	130	18	17	33	GERC11	M7	1	1.0	1.2	●
	BT40-SDC10P-70	1.0~10.0	70	32	31	45	GERC16	M10	1	1.0	1.2	●
	BT40-SDC10P-90	1.0~10.0	90	32	31	45	GERC16	M10	1	1.2	1.4	●
	BT40-SDC10P-130	1.0~10.0	130	32	31	45	GERC16	M10	2	1.4	1.5	●
	BT40-SDC13P-70	1.0~13.0	70	35	34	49	GERC20	M13	1	1.1	1.2	●
	BT40-SDC13P-90	1.0~13.0	90	35	34	49	GERC20	M13	1	1.2	1.4	●
	BT40-SDC13P-130	1.0~13.0	130	35	34	49	GERC20	M13	1	1.4	1.6	●
	BT40-SDC13P-150	1.0~13.0	150	35	34	49	GERC20	M13	1	1.6	1.8	●
	BT40-SDC16P-70	2.0~16.0	70	42	41	50	GERC25	M18	1	1.1	1.3	●
	BT40-SDC16P-90	2.0~16.0	90	42	41	50	GERC25	M18	1	1.3	1.5	●
	BT40-SDC16P-130	2.0~16.0	130	42	41	50	GERC25	M18	1	1.7	1.9	●
	BT40-SDC20P-70	2.0~20.0	70	50	-	60	GERC32	M22	2	1.1	1.3	●
	BT40-SDC20P-90	2.0~20.0	90	50	49	60	GERC32	M22	1	1.4	1.6	●
	BT40-SDC20P-130	2.0~20.0	130	50	49	60	GERC32	M22	1	1.9	2.2	●
	BT40-SDC20P-150	2.0~20.0	150	50	49	60	GERC32	M22	1	2.2	2.5	●
BT40-SDC26P-90	16.0~25.0	90	63	62	71	GERC40	M28	1	1.7	1.9	●	

(Unit : mm)

Chuck

Arbor/Modular

Boring tool

Angular head

cBN/PCD

TAUMAX

Other



HSK-SDC/P

Precision collet chuck for multi purpose machining

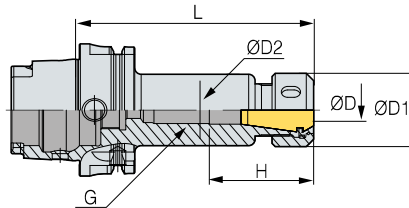

- : Stock
- H : Depth of tool insertion

C Internal coolant system is optional

※ Using oil hole types requires the standard dimension

- For more information on product features, see **86p**
- For more information on the related parts, see **92p**
- For more information on the applicable collet, see **95p**

	Designation	ØD	L	ØD1	ØD2	H	G	COLLET	Kg	Package weight(Kg)	Stock
HSK63A	HSK63A-SDC7P-100	1.0-7.0	100	18	17	33	M7	GERC11	0.9	1	
	HSK63A-SDC7P-120	1.0-7.0	120	18	17	34	M8	GERC11	0.9	1	
	HSK63A-SDC10P-100	1.0-10.0	100	32	31	44.5	M10	GERC16	1	1.1	●
	HSK63A-SDC10P-120	1.0-10.0	120	32	31	44.5	M10	GERC16	1	1.1	
	HSK63A-SDC13P-100	1.0-13.0	100	35	34	49	M7	GERC20	1.1	1.2	●
	HSK63A-SDC13P-120	1.0-13.0	120	35	34	49	M7	GERC20	1.2	1.4	
	HSK63A-SDC13P-150	1.0-13.0	150	35	34	49	M7	GERC20	1.2	1.4	
	HSK63A-SDC16P-100	2.0-16.0	100	42	41	50	M7	GERC25	1.2	1.4	●
	HSK63A-SDC20P-110	2.0-20.0	110	50	49	60	M7	GERC32	1.5	1.7	●
HSK63A-SDC26P-130	16.0-25.0	130	63	62	71	M10	GERC40	1.6	1.8		
HSK100A	HSK100A-SDC7P-100	1.0-7.0	100	18	17	33	M7	GERC11	2.0	2.2	
	HSK100A-SDC10P-100	1.0-10.0	100	32	31	44.5	M10	GERC16	2.2	2.4	
	HSK100A-SDC13P-100	1.0-13.0	100	35	34	49	M7	GERC20	2.4	2.6	
	HSK100A-SDC16P-110	2.0-16.0	100	42	41	50	M13	GERC25	2.6	2.9	●
	HSK100A-SDC20P-120	2.0-20.0	120	50	49	60	M10	GERC32	2.9	3.3	●
	HSK100A-SDC26P-130	16.0-25.0	130	63	62	71	M28	GERC40	3.8	4	

(Unit : mm)

Accessories

SPARE PART	Type	Accessories
	Images	
	Model No.	
	HSK63A	HSK63A-CNS
	HSK100A	HSK100A-CNS



SK-SDC/P

Precision collet chuck for multi purpose machining

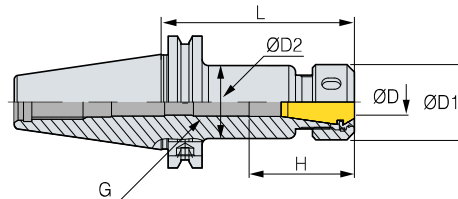

- ● : To be discontinued
- ● : Stock
- H : Depth of tool insertion

C Internal coolant system is optional

※ Using oil hole types requires the standard dimension

- For more information on product features, see **86p**.
- For more information on the related parts, see **92p**.
- For more information on the applicable collet, see **95p**.

	Designation	ØD	L	ØD1	ØD2	H	COLLET	G	Kg	Package weight(Kg)	Stock
SK40	SK40-SDC10P-90	1.0~10.0	90	32	31	44.5	GERC16	M10	1.1	1.2	●
	SK40-SDC13P-90	1.0~13.0	90	35	34	49	GERC20	M13	1.2	1.3	●
	SK40-SDC13P-120	1.0~13.0	120	35	34	49	GERC20	M13	1.3	1.5	●
	SK40-SDC16P-90	2.0~16.0	90	42	41	50	GERC25	M18	1.4	1.5	●
	SK40-SDC20P-90	2.0~20.0	90	50	49	60	GERC32	M13	1.5	1.6	●

(Unit : mm)



SDC/P SPARE PART

ER collet chuck related parts

SPARE PART	Type	Main components		Accessories	
		Sleeve bearing nut	Adjust screw	Spanner	Collet
	Images				
	Model No.				
	SDC7P	RN11	BN0716F	20-22	GERC/ER 11-ØD
	SDC10P	RN16	BN1025F	32-35	GERC/ER 16-ØD
	SDC13P	RN20	BN1325F	35-38	GERC/ER 20-ØD
	SDC16P	RN25	BN1830F	42-46	GERC/ER 25-ØD
	SDC20P	RN32	BN2230F	48-52	GERC/ER 32-ØD
	SDC26P	RN40	BN2838F	62-65	GERC/ER 40-ØD

※ BT30-SDC13P-50/ HSK63A-SDC13P-100 is applied with BN0716F screw.